

Learning Estate Update

April 2021

robbie.crockatt@edinburgh.gov.uk

Learning Estate Update

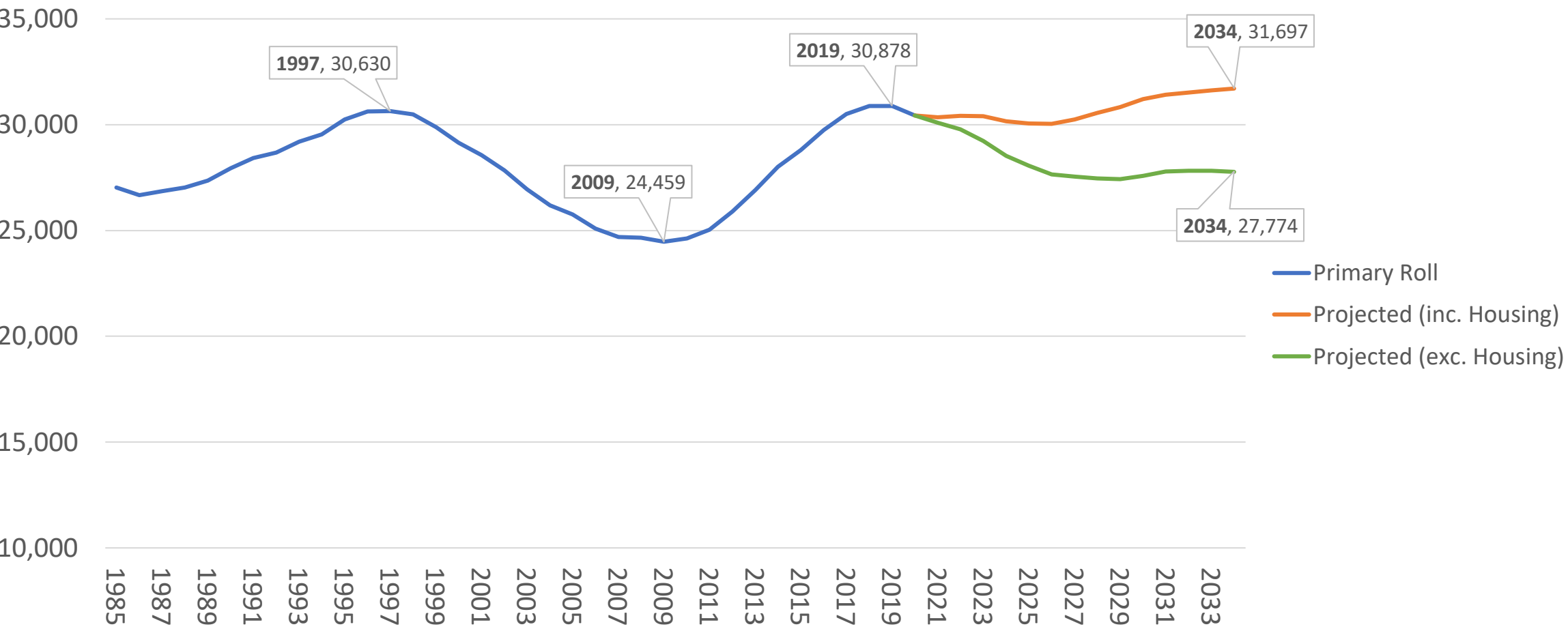
April 2021

- Rolls & Projections
- Early Years
- Primary
- Secondary
- Opportunities & Challenges

robbie.crockatt@edinburgh.gov.uk

Rolls & Projections

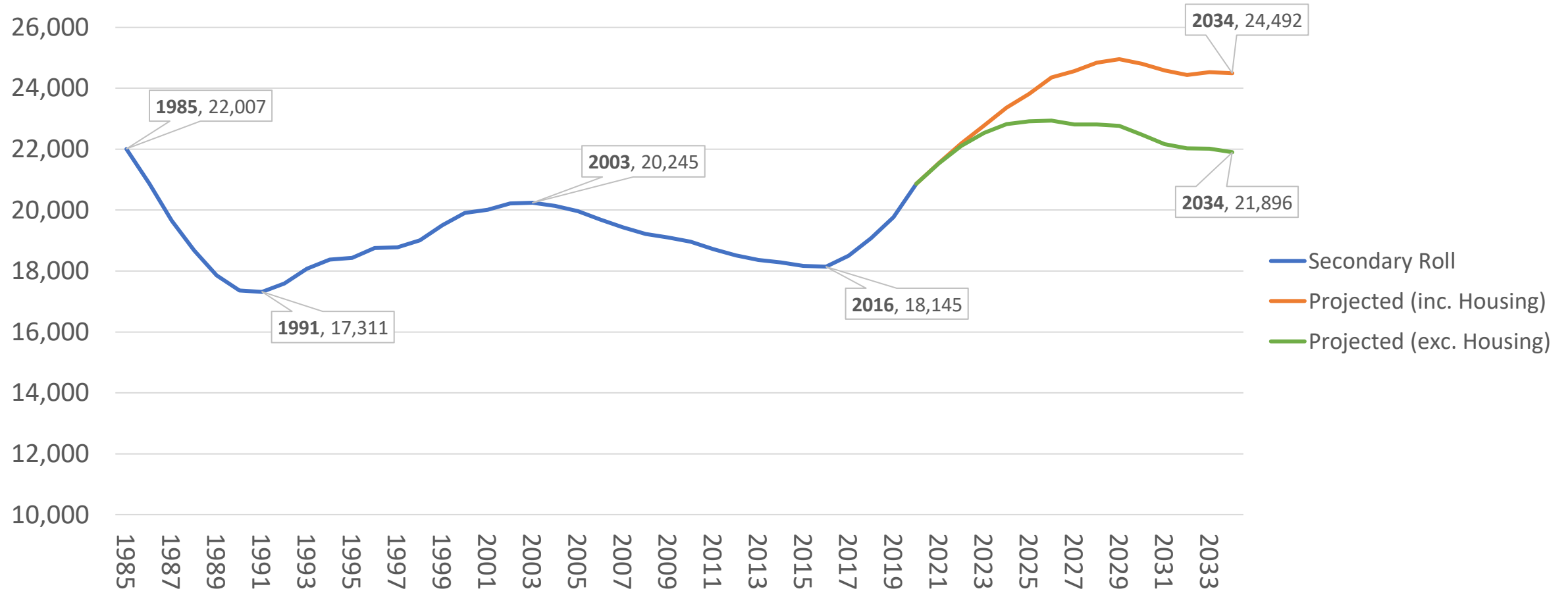
Primary Rolls, Actual 1985-2020, Projected with and without Pupil Generation from New Housing 2021-2033



<https://www.edinburgh.gov.uk/school-places/school-roll-projections/1>

Rolls & Projections

Secondary Rolls, Actual 1985-2020, Projected with and without Pupil Generation from New Housing 2021-2033



<https://www.edinburgh.gov.uk/school-places/school-roll-projections/1>

Early Years

5 ABC Nurseries

Craigentenny | Granton | Nether Currie | St John Vianney RC | St Marks RC



St John Vianney Nursery Nov 2020

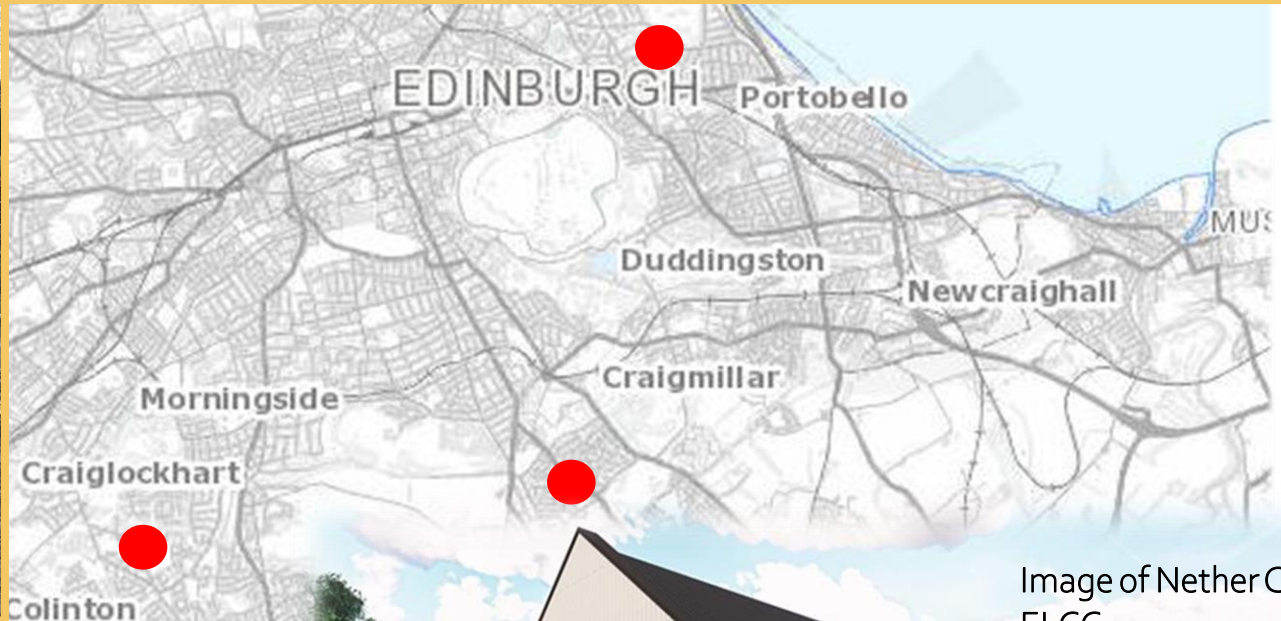
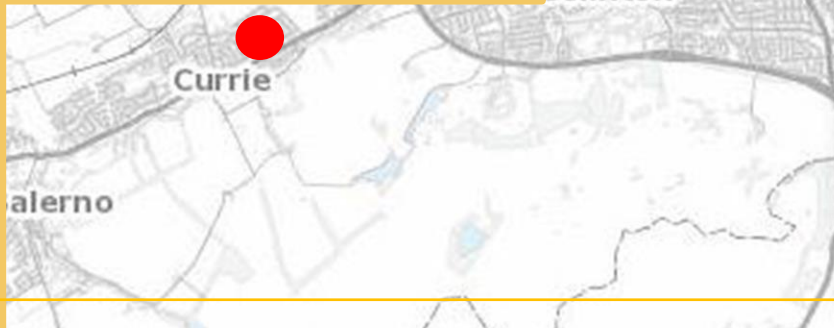
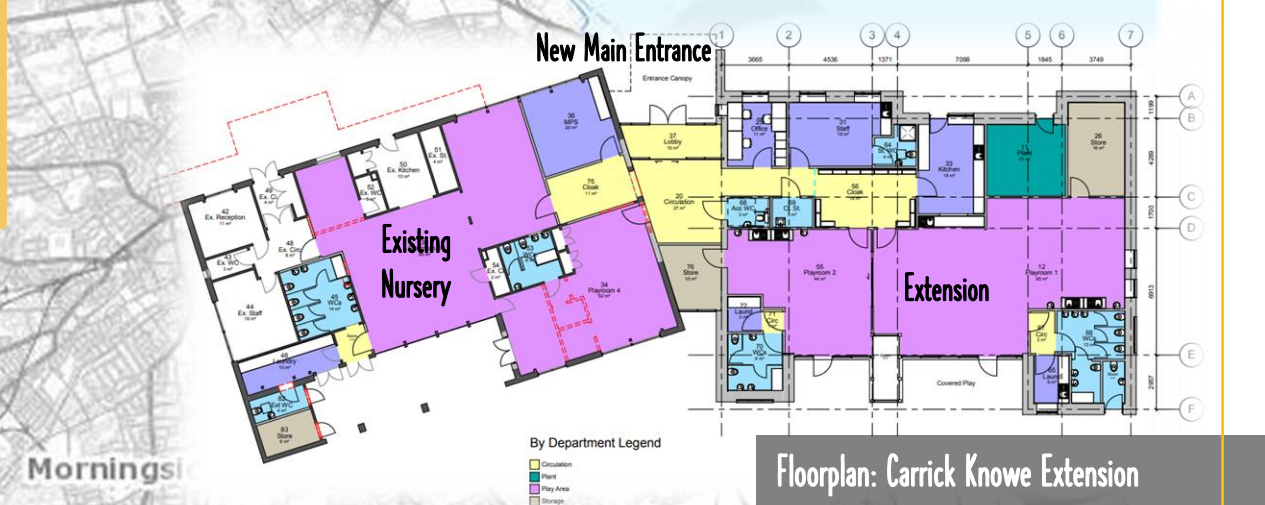
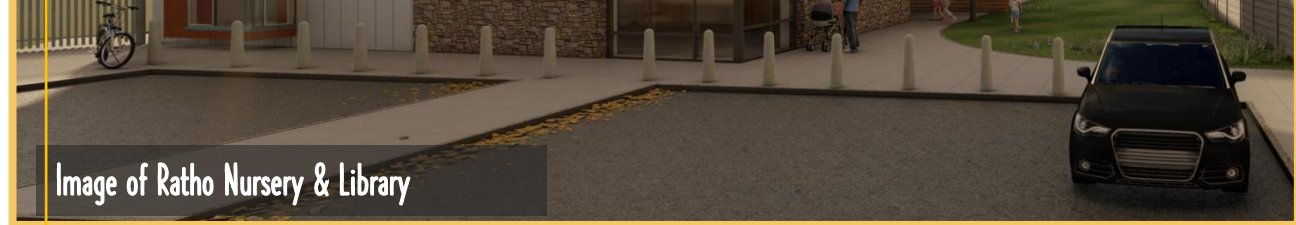


Image of Nether Currie ELCC





3 CEC Nurseries



Floorplan: Carrick Knowe Extension

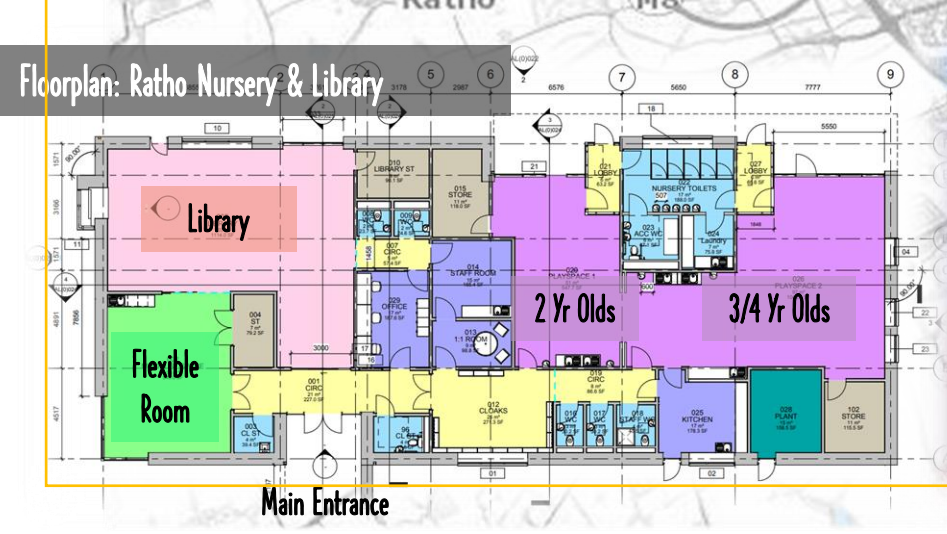
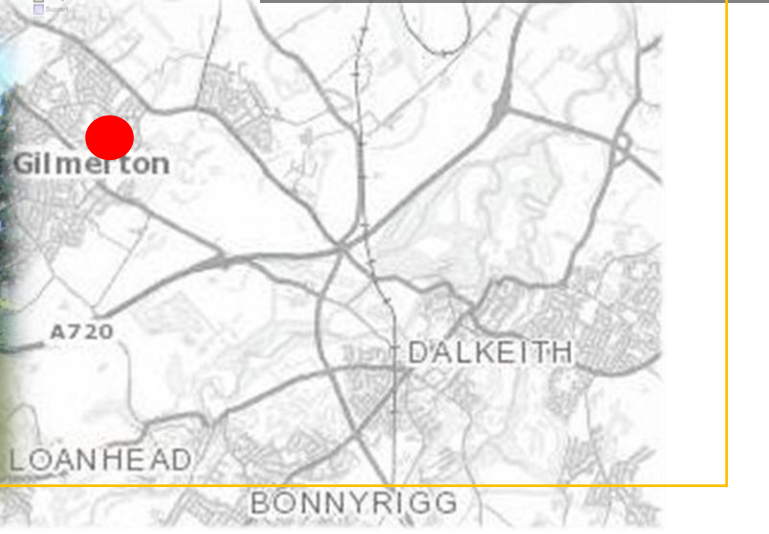


Image of Spinney Lane Nursery Extension

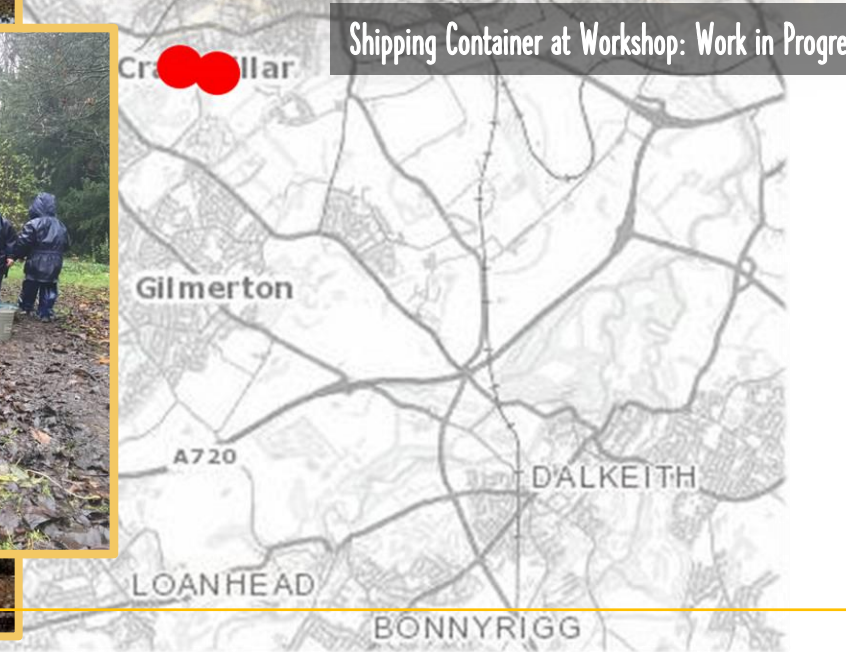


Forest Kindergarten

Queenferry | Cammo | Corstorphine Hill | Hawkhill (Craigmillar) | Castlebrae

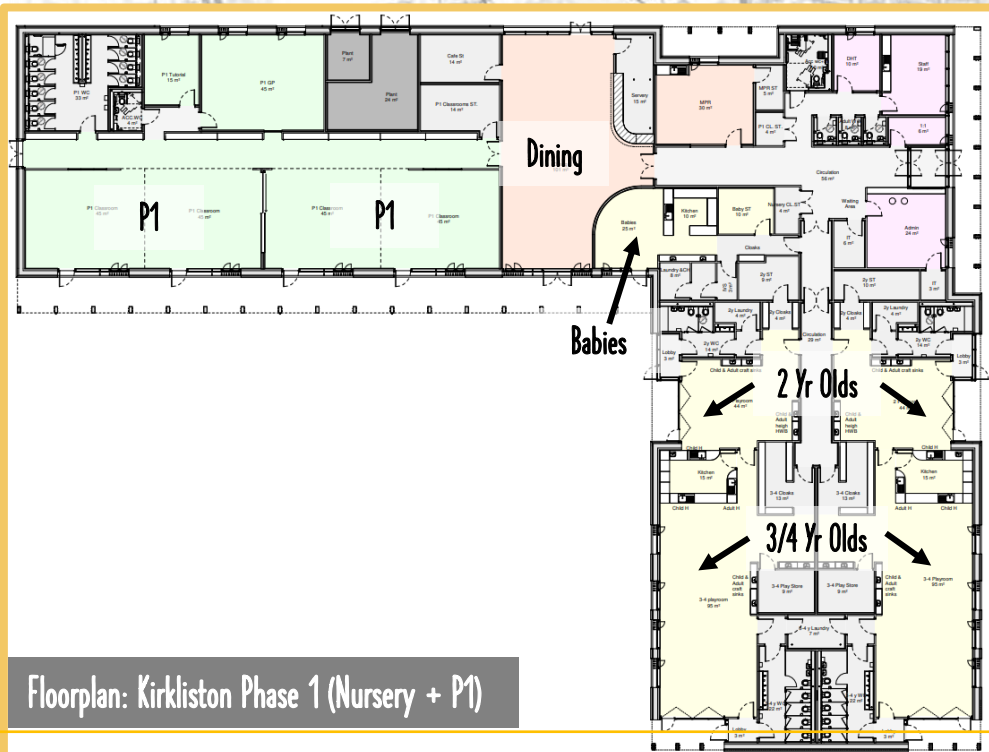


Image of Forest Kindergarten Base



Kirkliston

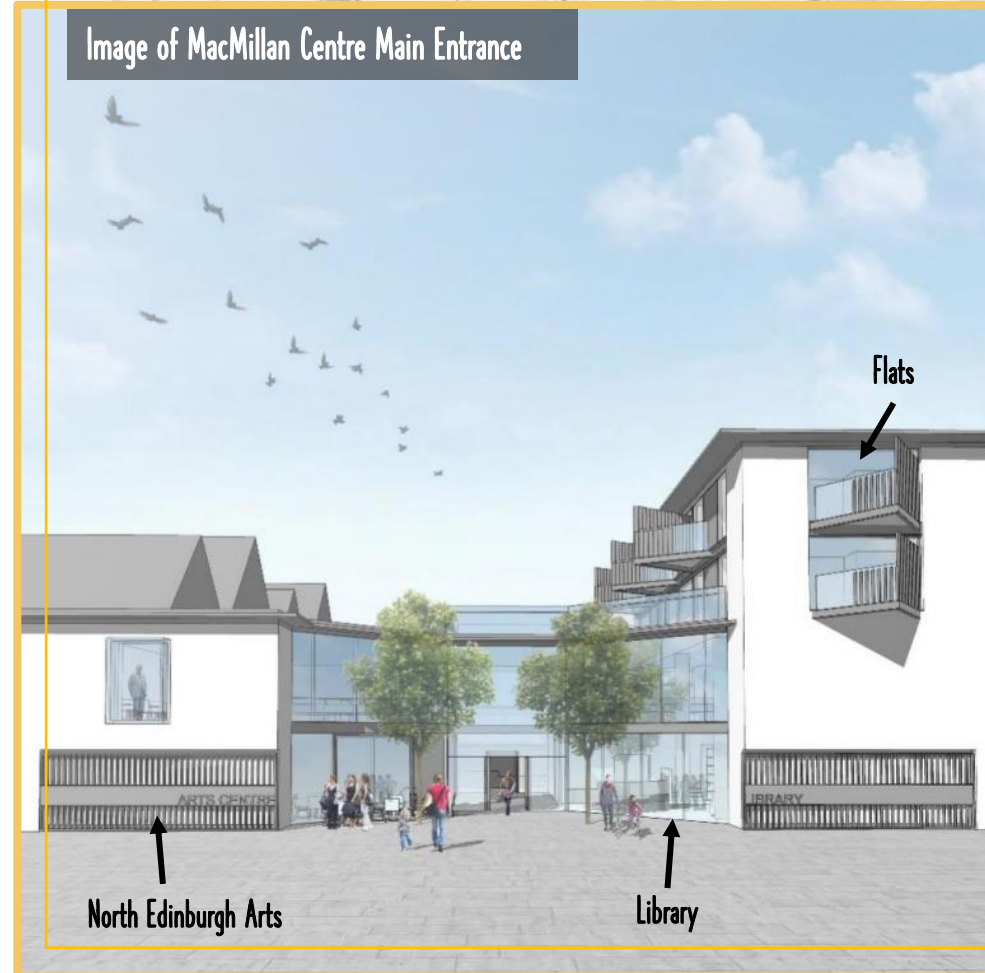
Early Level Campus on Leisure Centre Site



Pennywell

MacMillan Hub – Library, Early Years, Housing and North Edinburgh Arts

Image of MacMillan Centre Main Entrance





Powderhall

Nursery and Older Peoples Housing

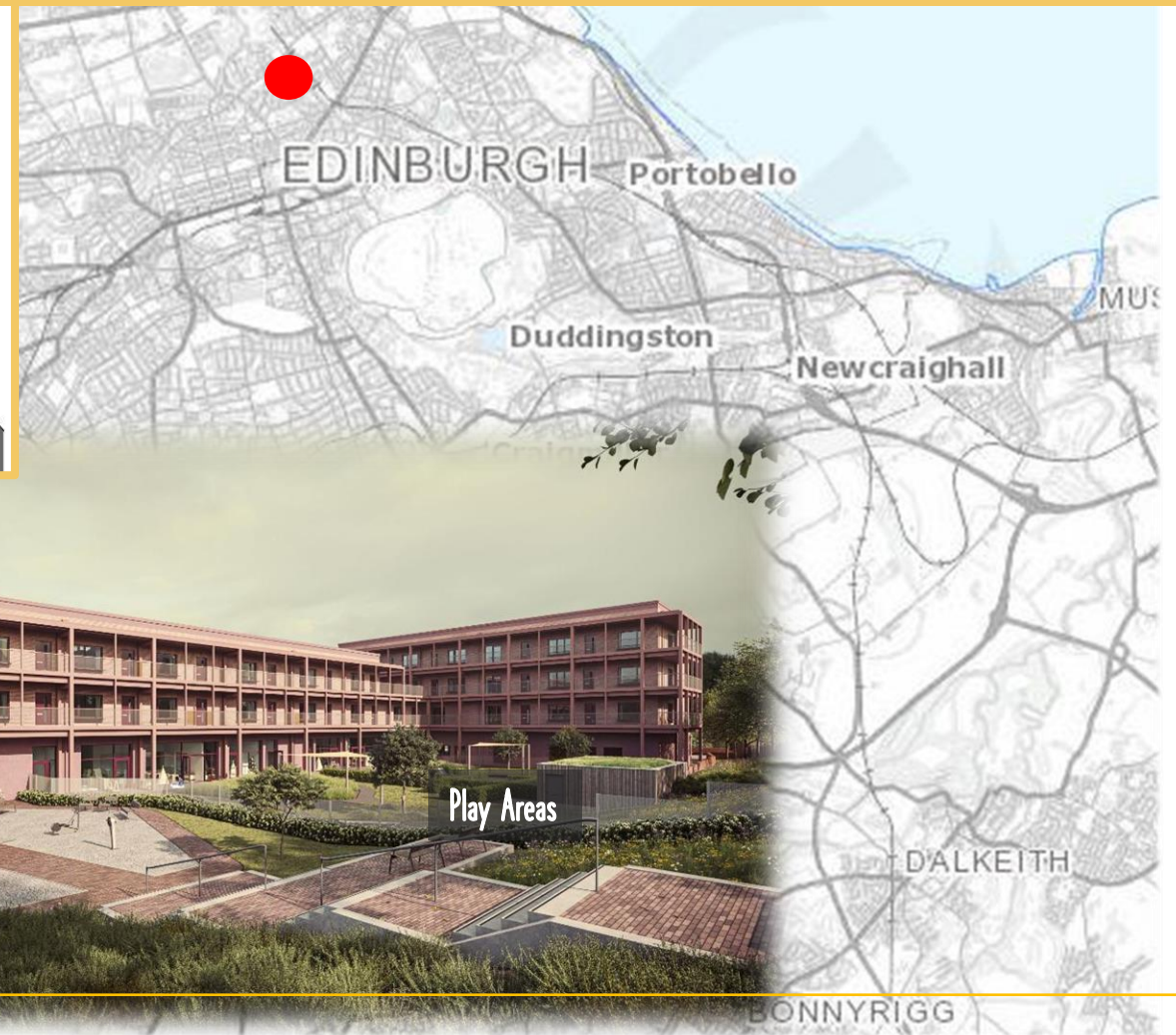


Image of Powderhall ELCC Main Entrance



Play Areas

Primary

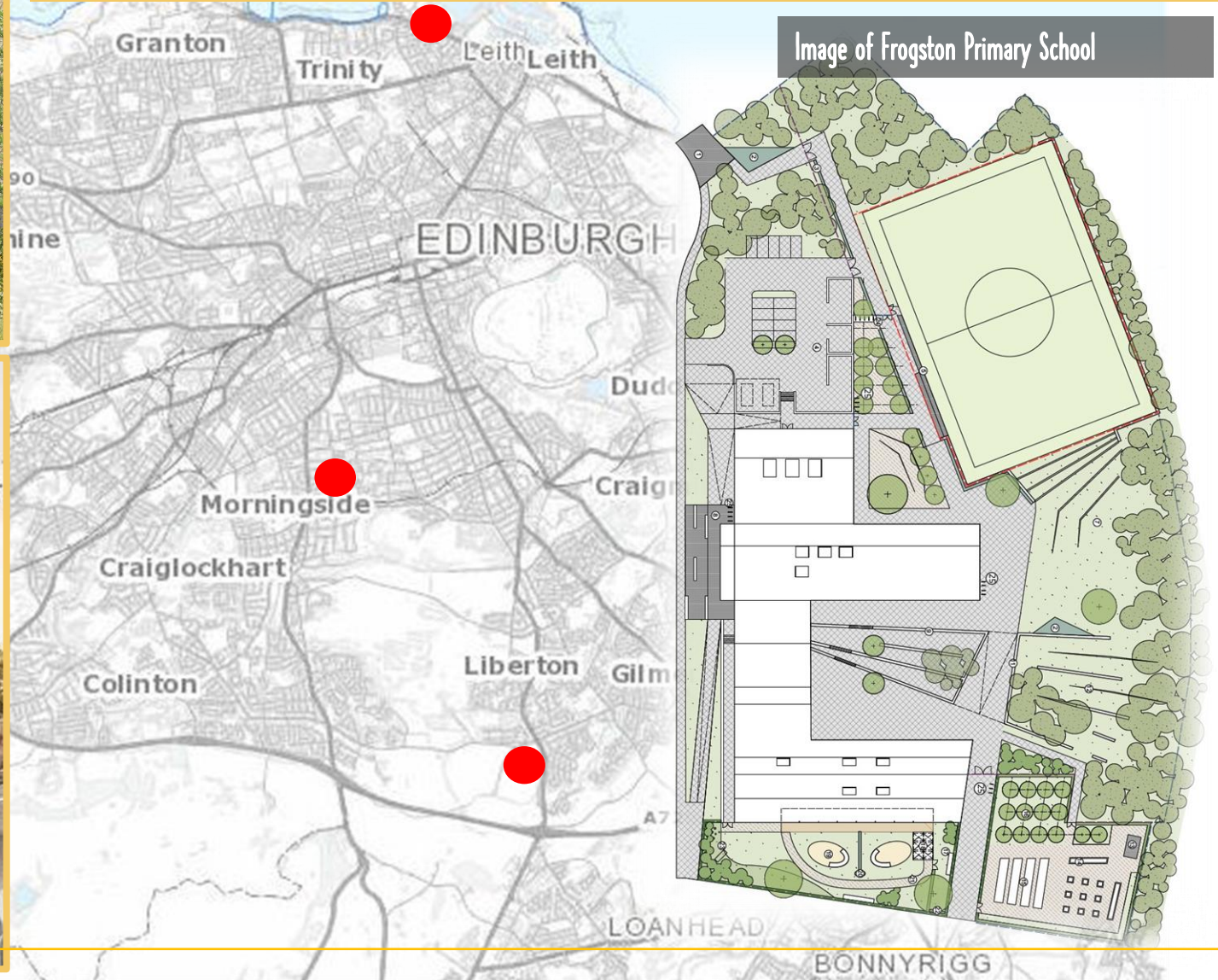
Victoria, Frogston & Canaan Lane



Image of Frogston Primary School



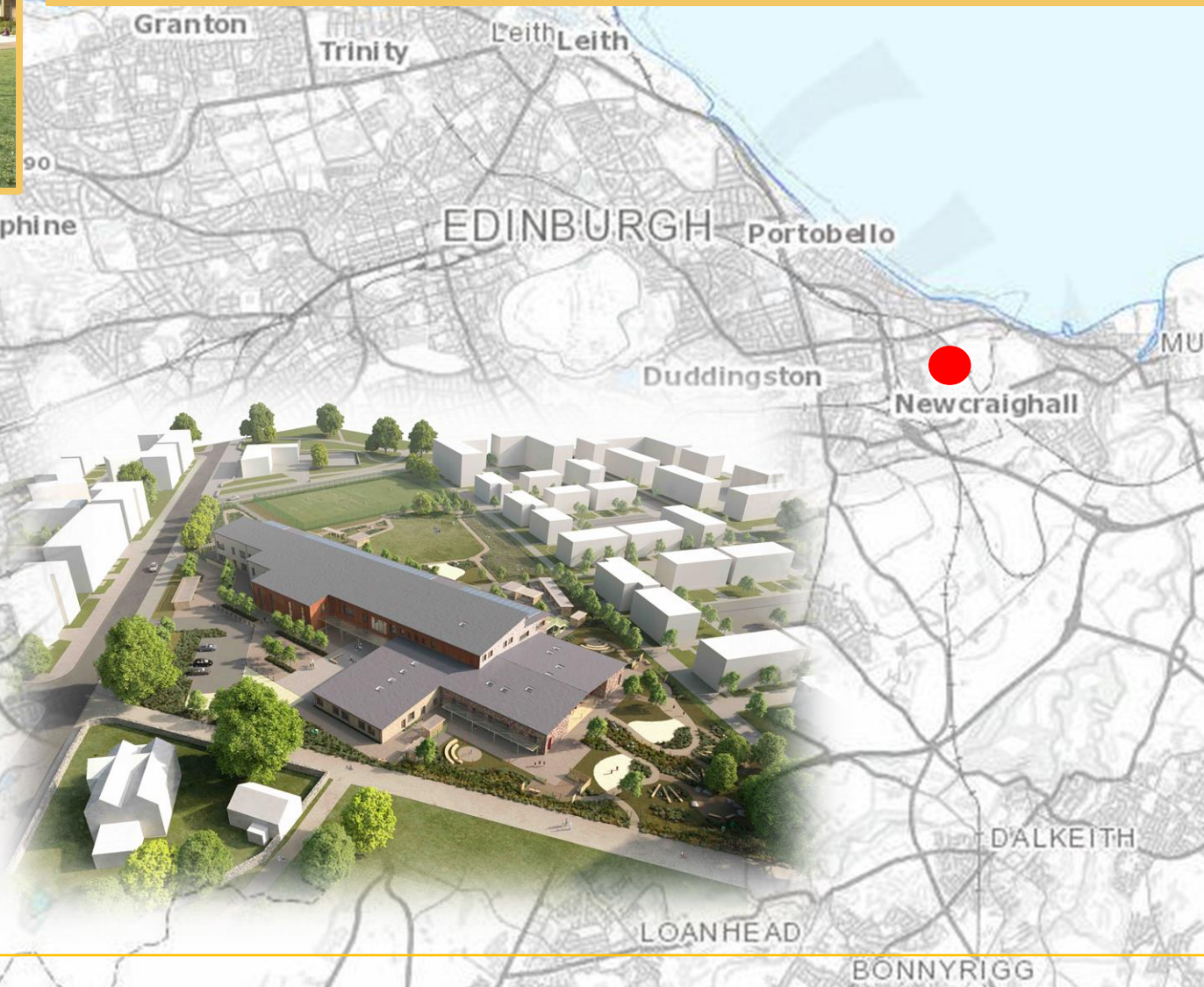
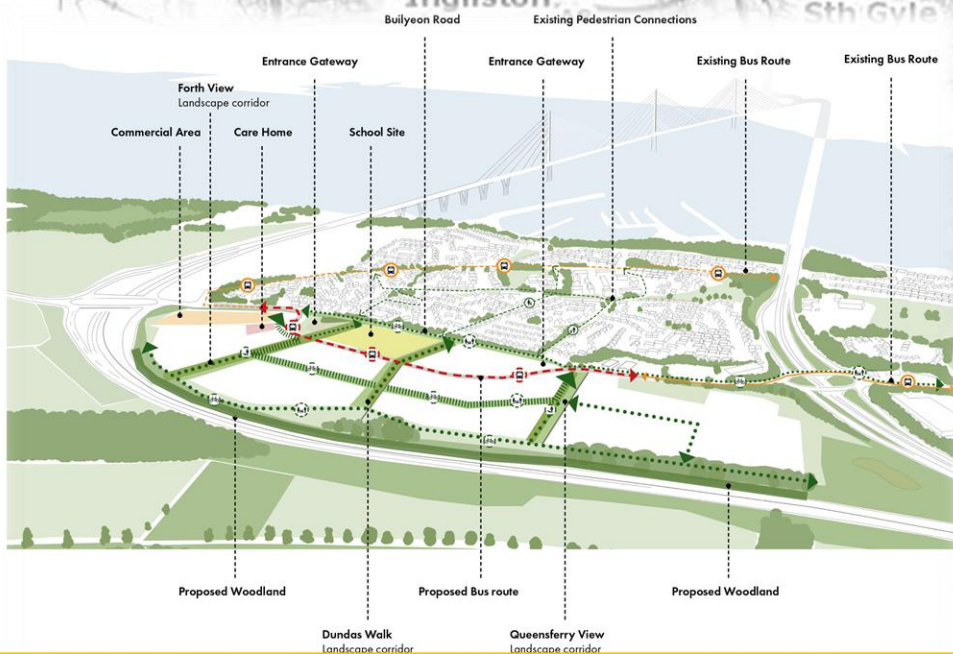
Image of South Edinburgh Primary School



Maybury, Newcraighall & Builyeon Rd



Builyeon Road Masterplan with School Site



A map of the Queensferry area. The Forth Road Bridge is shown crossing the Firth of Forth. The town of Queensferry is labeled. The A90 road is shown running through the town. A red dot is placed on the A90 road, indicating the location of the bus stop.



Floorplan: Proposed Sciennes Classroom Building

St Catherine's RC



St Catherine's RC Primary School



Proposed Uses

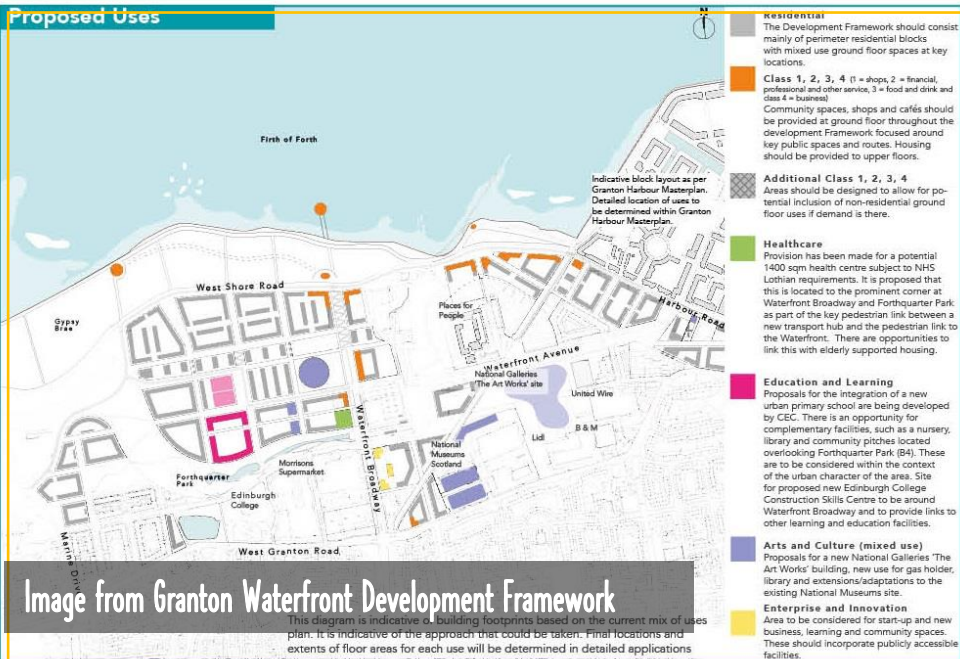


Image from Granton Waterfront Development Framework

This diagram is indicative of building footprints based on the current mix of uses plan. It is indicative of the approach that could be taken. Final locations and extents of floor areas for each use will be determined in detailed applications.

Granton Waterfront, East of Milburn Tower & Gilmerton Station Road

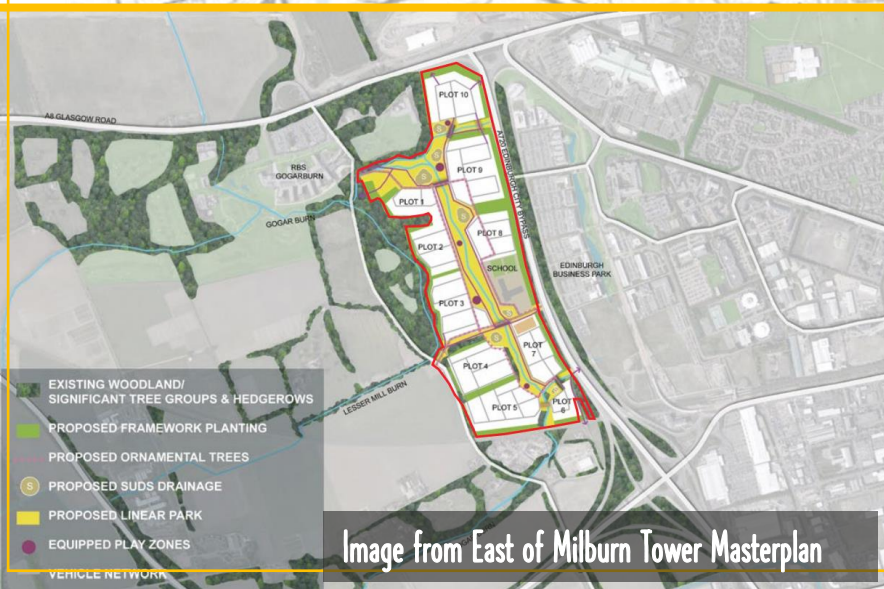


Image from East of Milburn Tower Masterplan



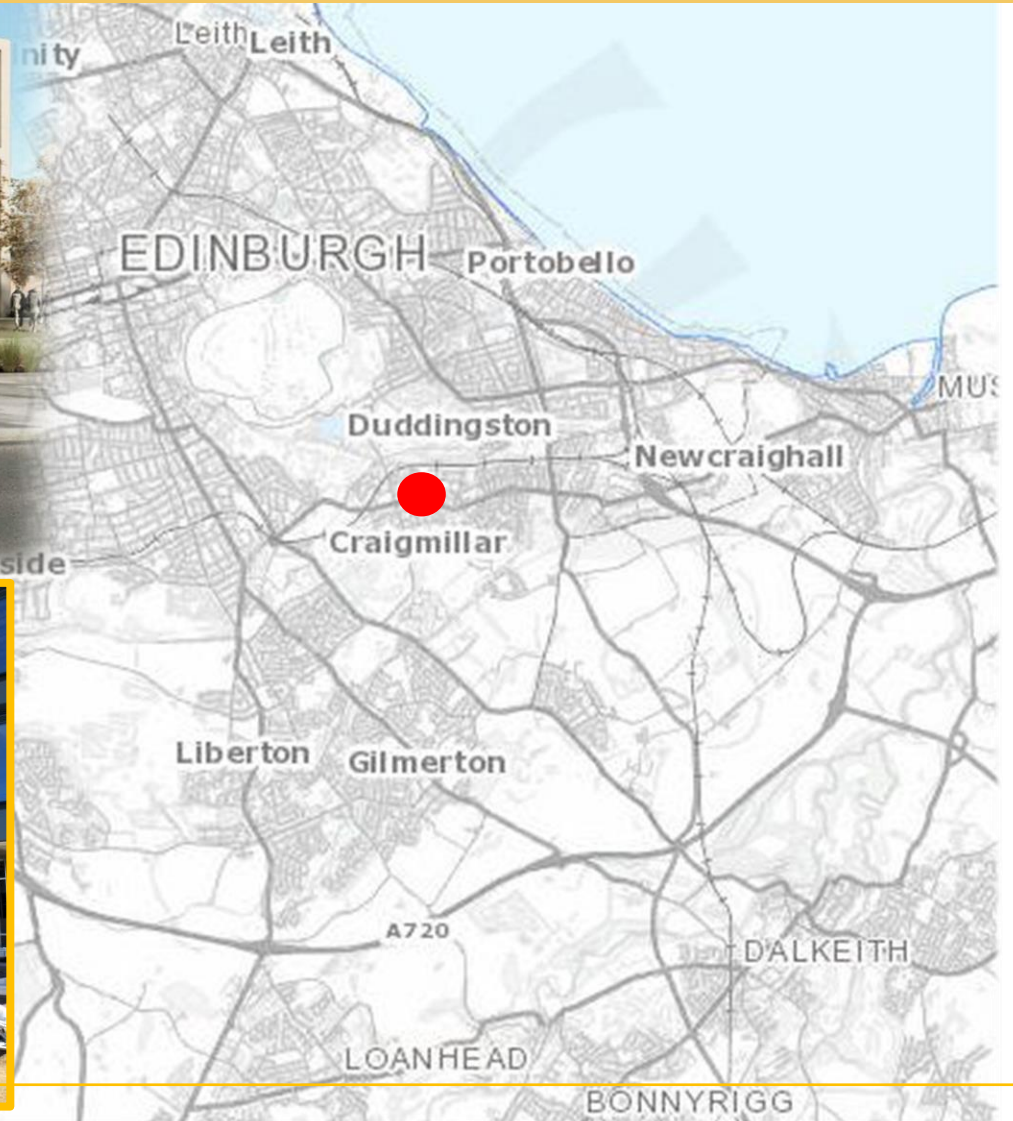
Image from East of Milburn Tower Masterplan

Secondary

Castlebrae Community Campus



Image of Castlebrae High School



Inside New Castlebrae - April 2021



April 2021

Trinity Academy

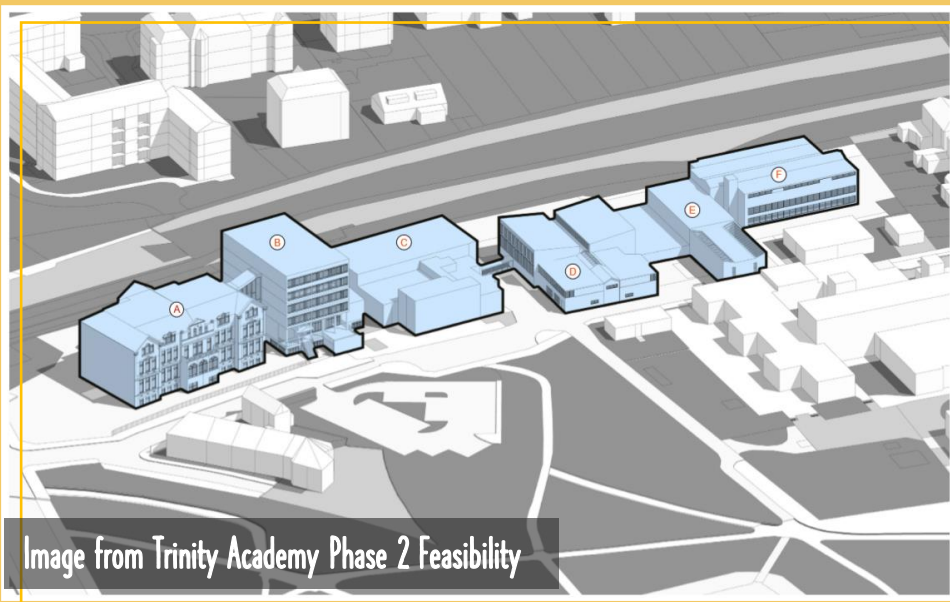


Image from Trinity Academy Phase 2 Feasibility

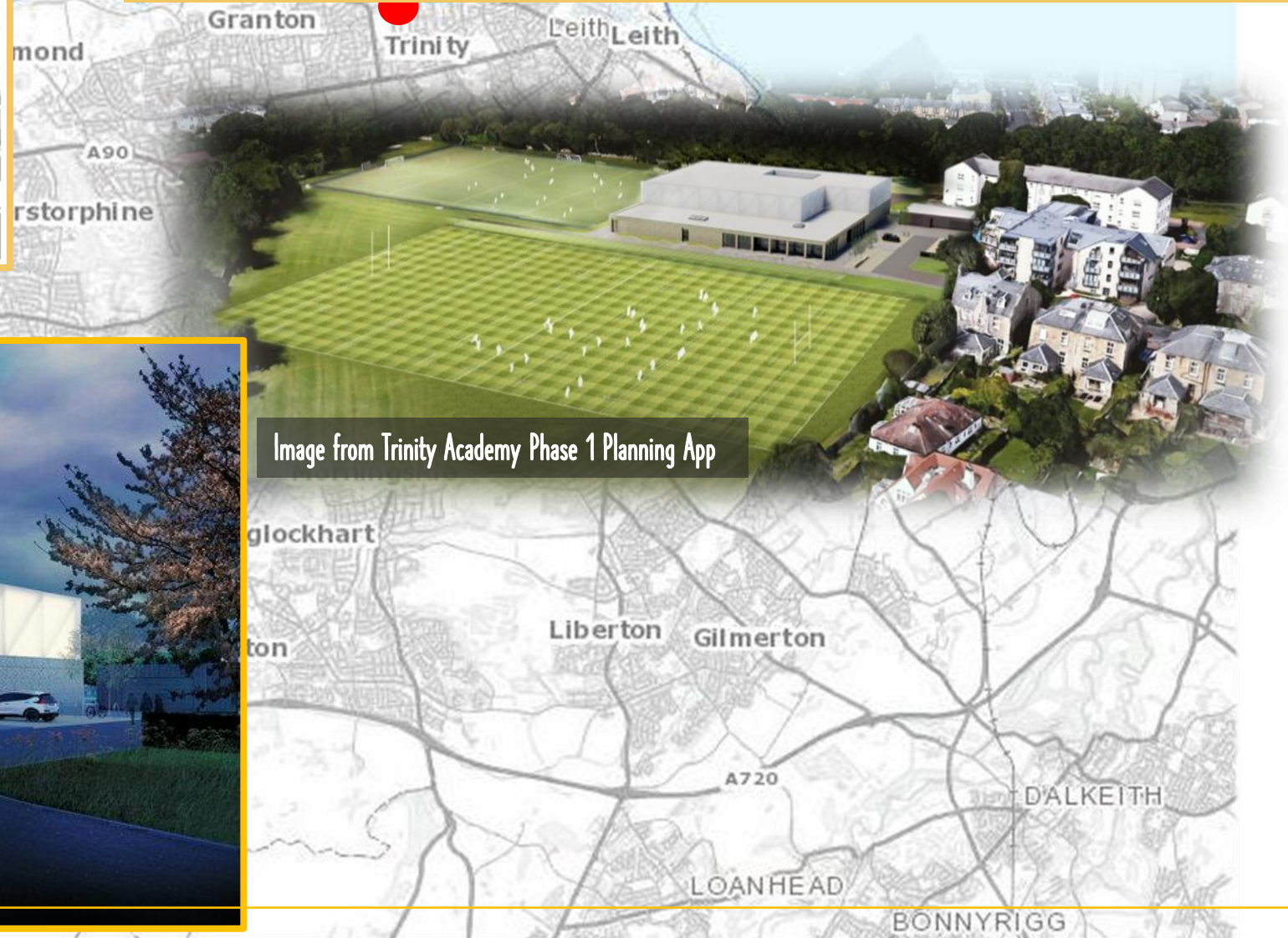
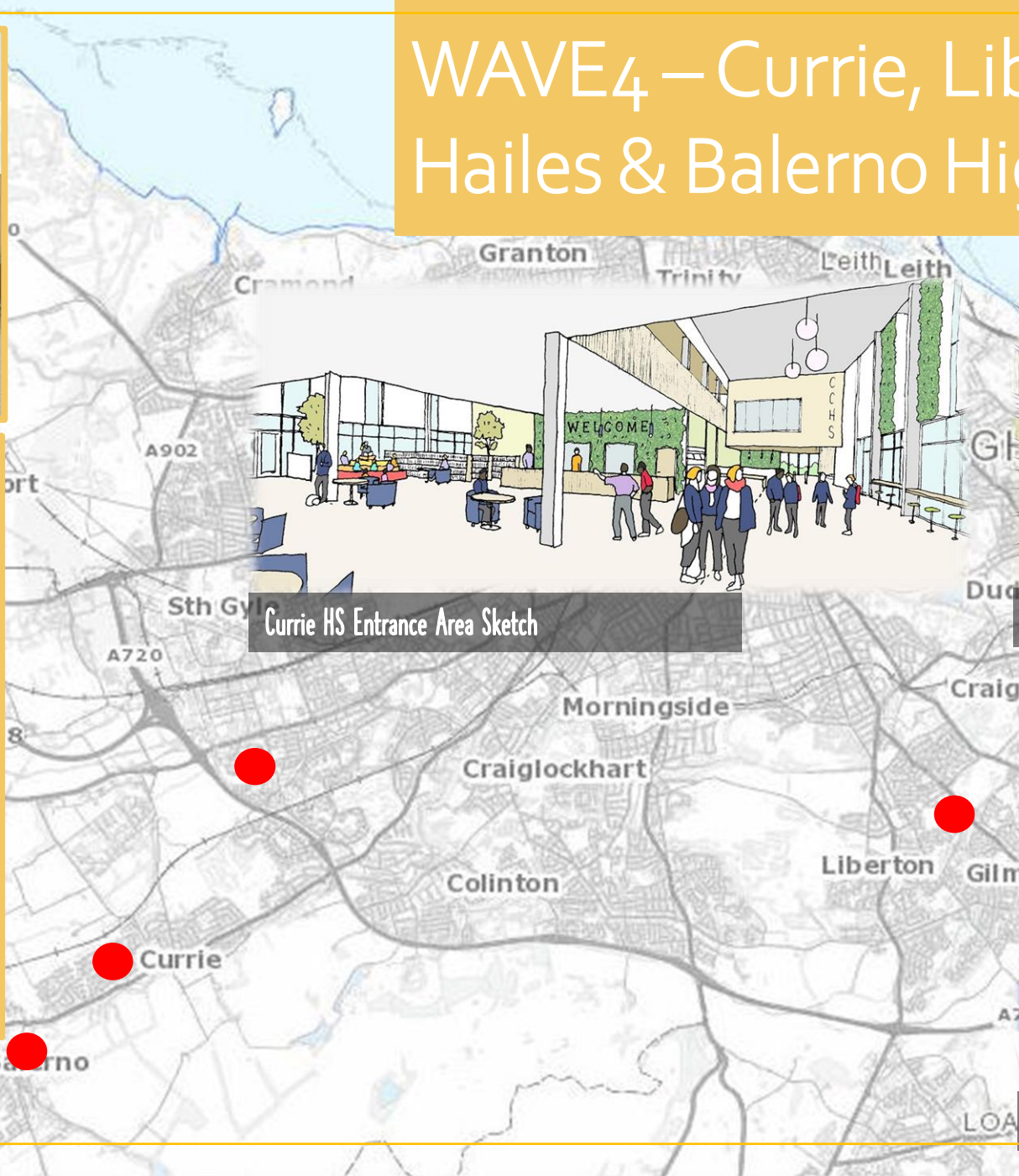
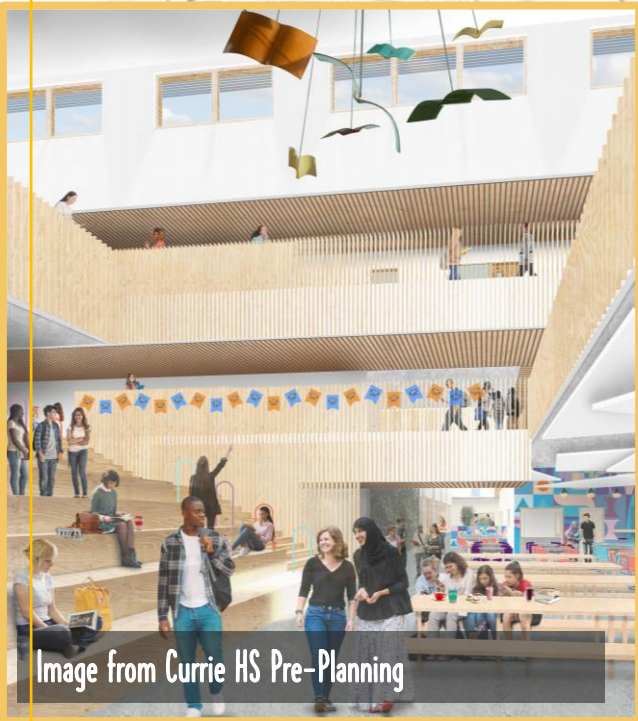


Image from Trinity Academy Phase 1 Planning App



Image from Trinity Academy Phase 1 Planning App

WAVE4 – Currie, Liberton, Wester Hailes & Balerno High Schools



James Gillespie's High School & Gaelic Medium Education

Forth Road Bridge

QUEENSFERRY

A90

A90

Image from Darroch Planning App



Granton

Trinity

Leith

EDINBURGH

Portobello

Duddingston

Newcraighall

Morningside

Craigmillar

Lockhart

Liberton

Gilmerton

A720

LOANHEAD

DALKEITH

BONNYRIGG

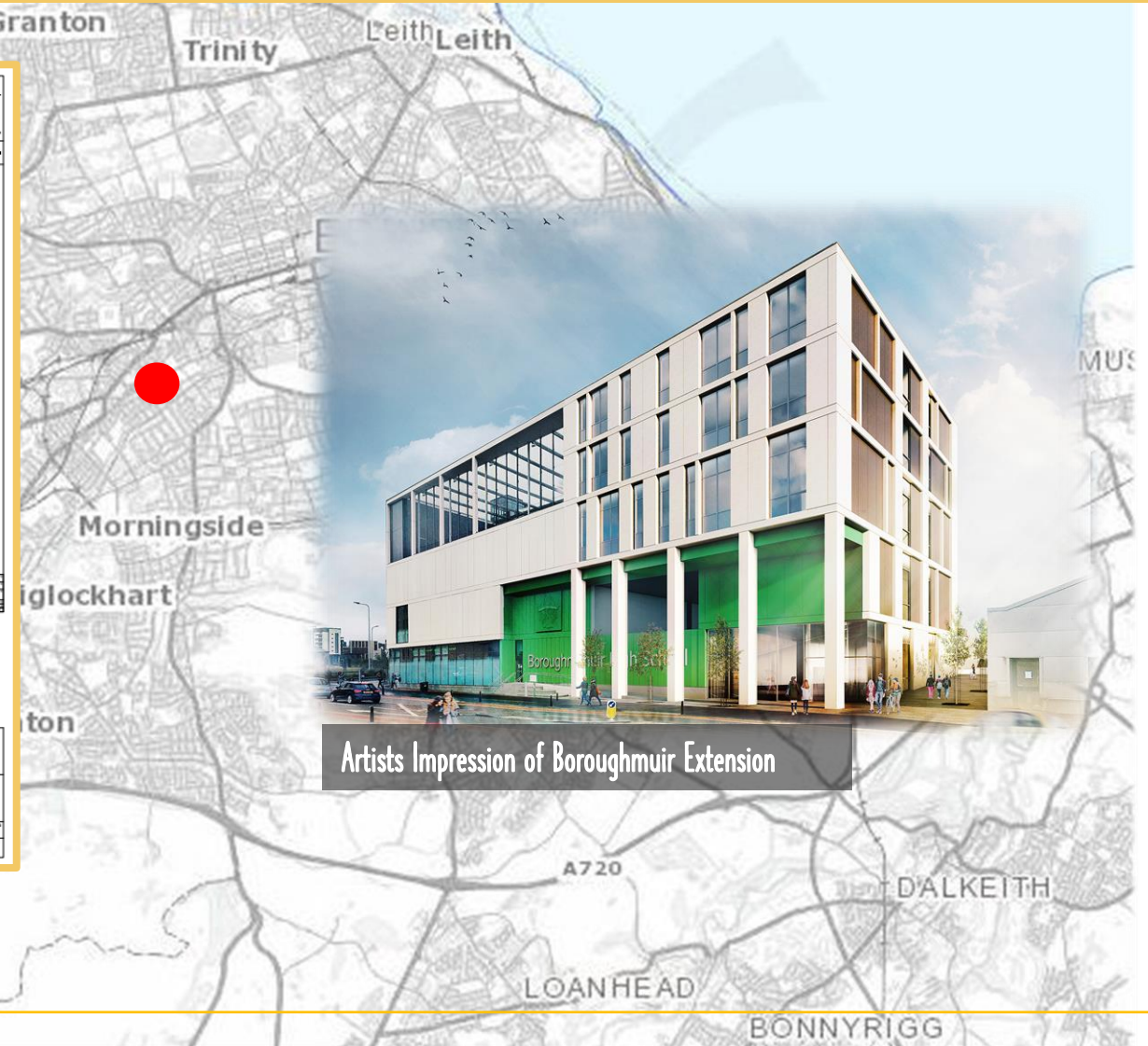
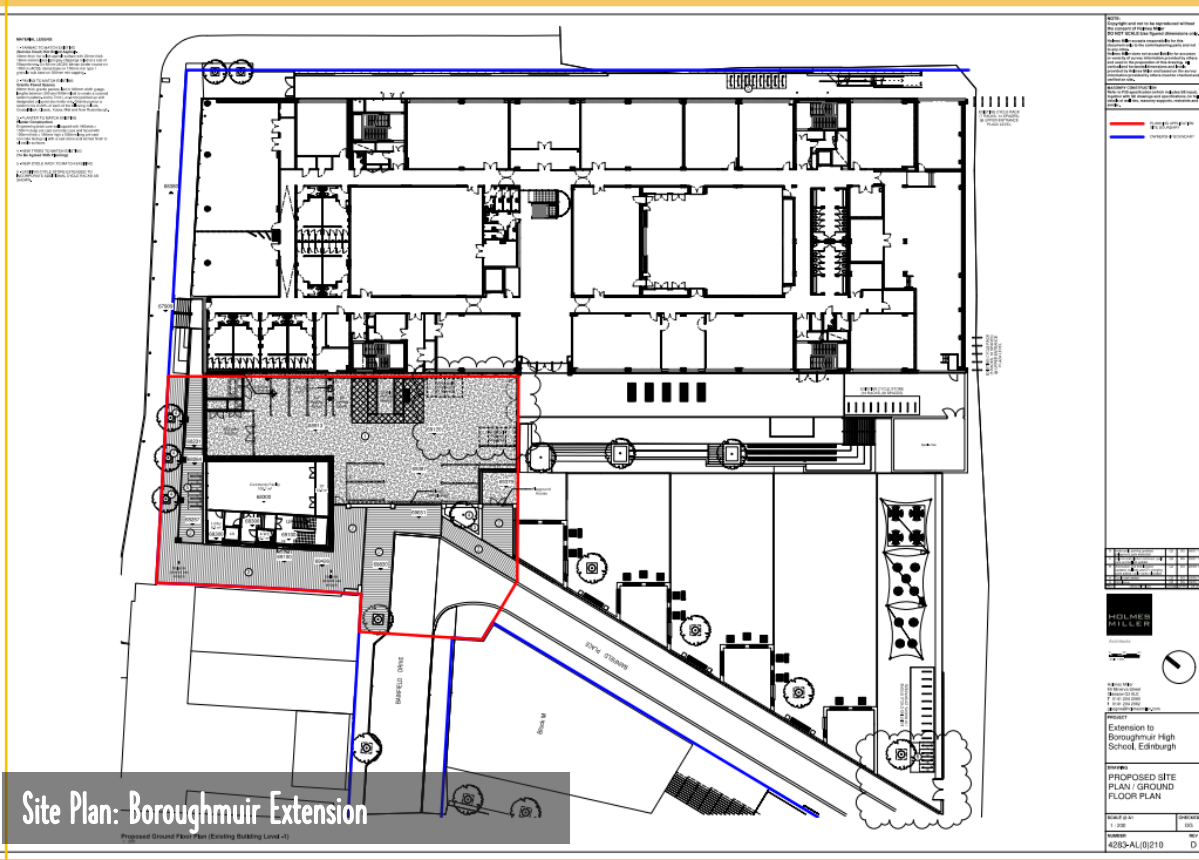


Darroch, Upper Gilmore Place



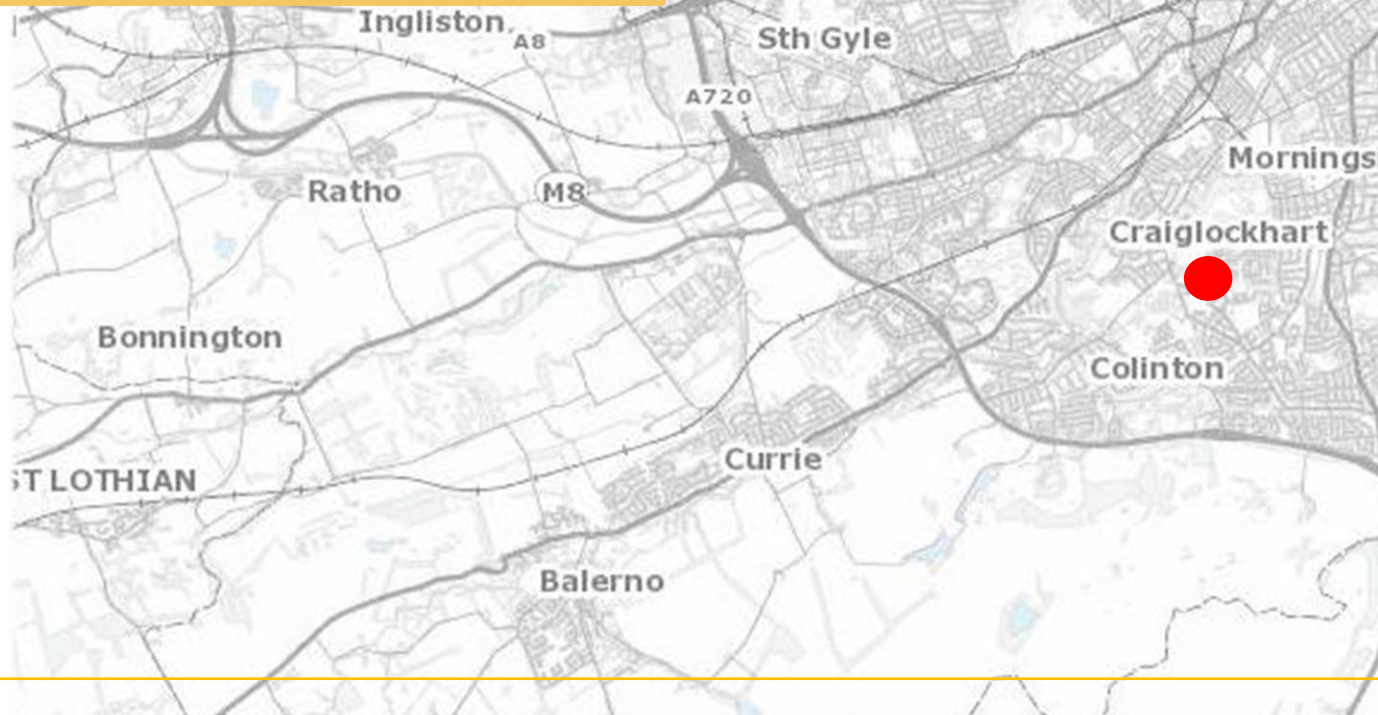
Darroch, Upper Gilmore Place

Boroughmuir High School



Craigroyston, Firhill & The Royal High School

Concept Image of MacMillan Centre Main Entrance



The Royal High Extension Site (outlined in red)

Opportunities & Challenges

- Impact of City Plan
 - New Schools?
 - Schools as Community Hubs
- Changes in Learning & Teaching
 - Digital
 - Outdoor Learning
 - Inclusion
- Expansion of Free Meals
- Zero Carbon



Thank You

robbie.crockatt@edinburgh.gov.uk

◆ EDINBURGH ◆
THE CITY OF EDINBURGH COUNCIL